

# LANDSCAPING PLAN

Customer Name: \_\_\_\_\_ Address: \_\_\_\_\_  
 Phone: \_\_\_\_\_

The following landscape package is considered to be a standard package.

**ANY CHANGES TO THE STANDARD PACKAGE ARE CONSIDERED UPGRADES**  
 (\$500 charge for any changes made to the standard package)

\*All installations include black mulch around planting areas.

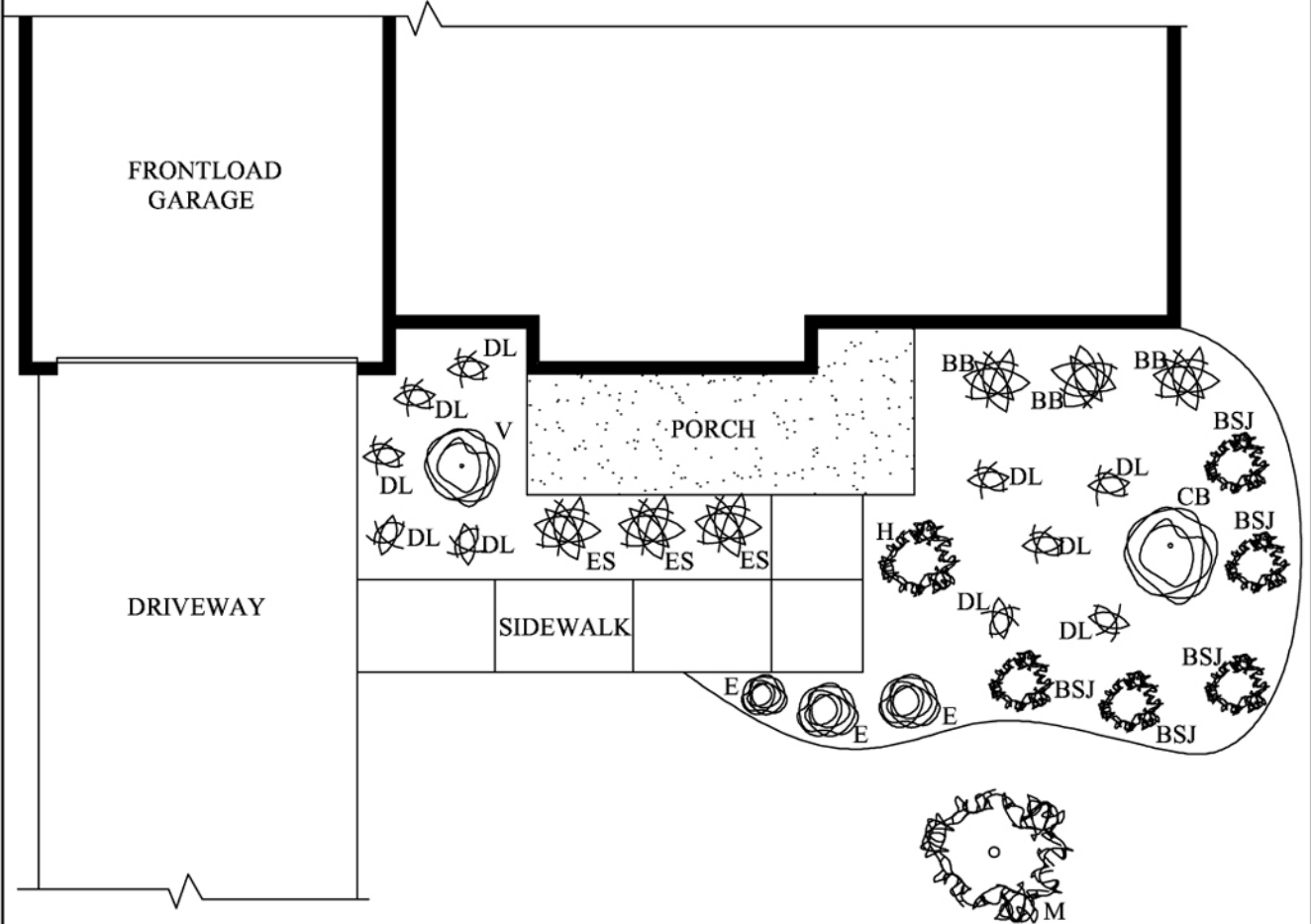

CUSTOMER SIGNATURE: \_\_\_\_\_

CUSTOMER SIGNATURE: \_\_\_\_\_

EXAMPLE

- V - Viburnum (7 gal.)
- DL - Day Lily (1 gal.)
- CB - Crab Tree (1.5-2.0 cal.)
- BB - Burning Bush (24"-30")
- E - Euonymus Emerald Green (3 gal.)
- H - Hydrangea (5 gal.)
- ES - Evergreen Spread Yew (24"- 30")
- M - Maple Red Sunset (2-2.5 cal.)
- BSJ - Blue Sargent Juniper (3 gal.)

Disclaimer: It is the Homeowner's responsibility to properly water and care for plantings per the Homeowner's Handbook. Drawings are not to scale and the actual layouts will vary according to house design and site conditions. Plantings may change slightly due to availability, but will be of equal or greater value.

Landscaping is NOT under warranty, but we will perform a one-time visit within 6-months of closing if needed.

